

# Instructions

## VG, VGF, VGS, VGU, VGUF

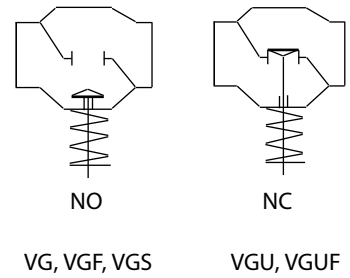

Valve type	PN	T <sub>max.</sub> (°C)	T <sub>min.</sub> (°C)
VG	25	150	2
VGF	25	150	2
VGS	25	200	2
VGU	25	150	2
VGUF	25	150	2

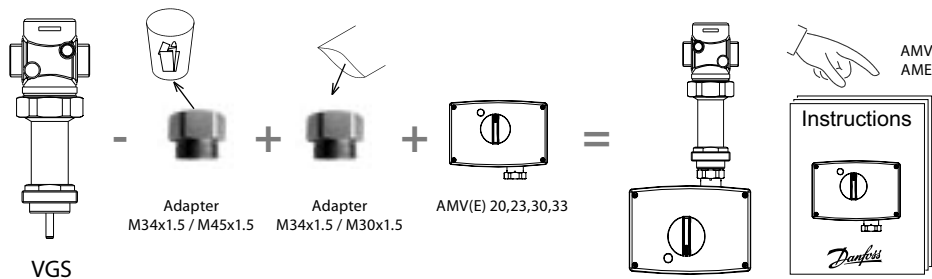
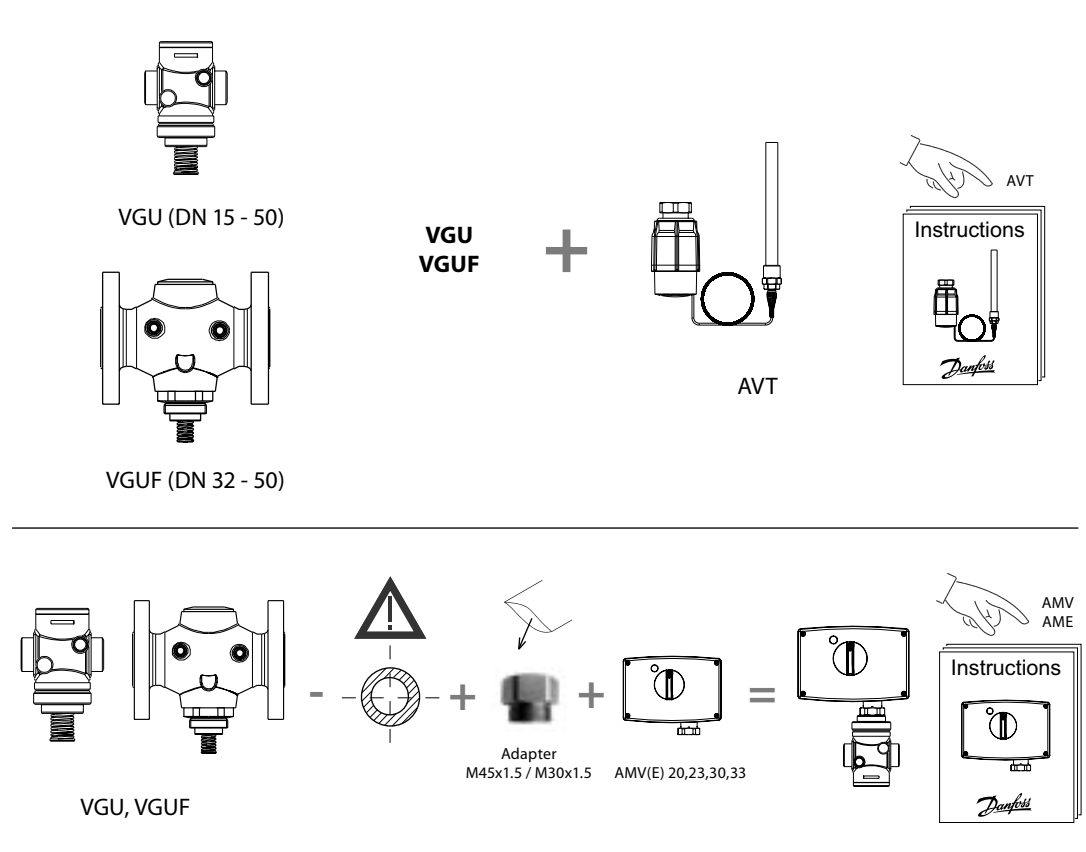
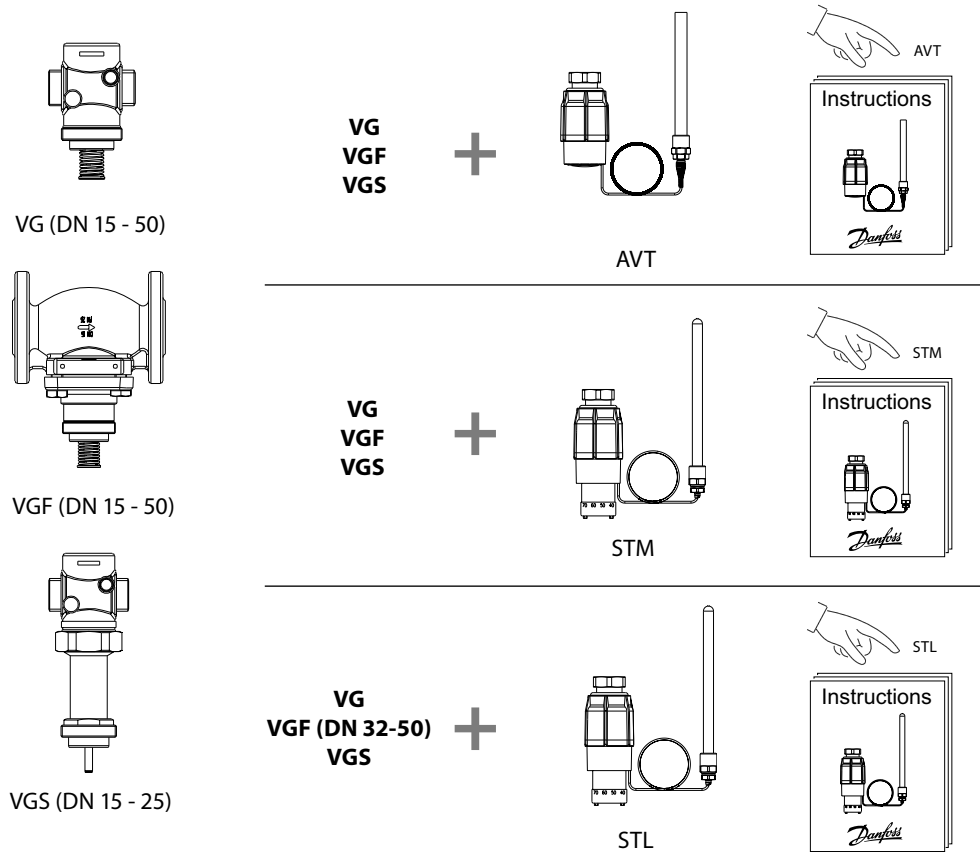
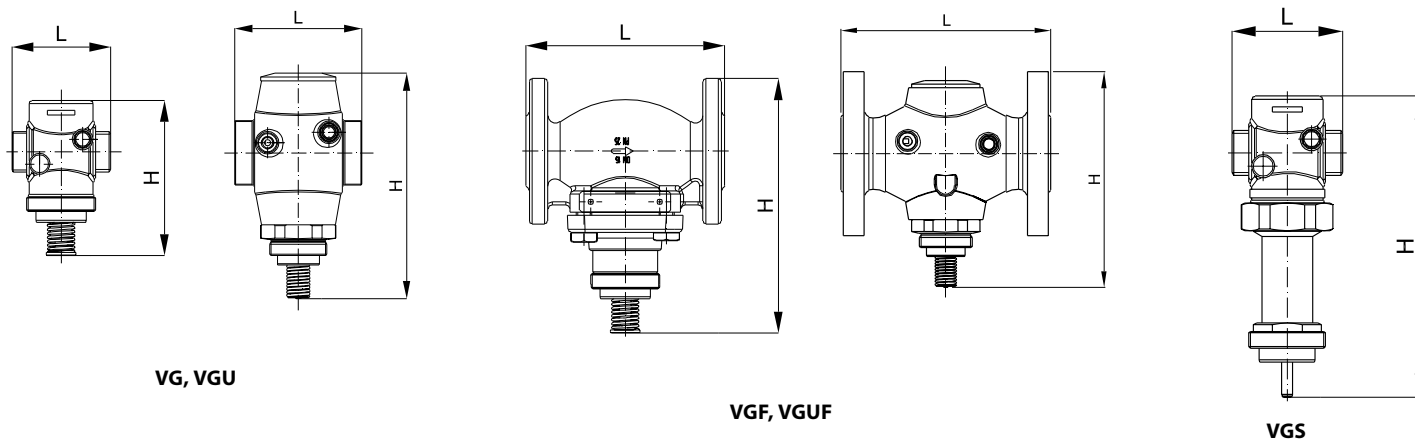

DN			15	20	25	32	40	50
VG	L	mm	65	70	75	100	110	130
	H	mm	102	102	102	176	176	176
VGF	L	mm	130	150	160	180	200	230
	H	mm	165	172	175	184	189	196
VGS	L	mm	65	70	75	-	-	-
	H	mm	176	176	179	-	-	-
VGU	L	mm	65	70	75	100	110	130
	H	mm	105	105	107	173	173	173
VGUF	L	mm	-	-	-	180	200	230
	H	mm	-	-	-	180	185	193

Note: other flange dimensions - see table for tailpieces

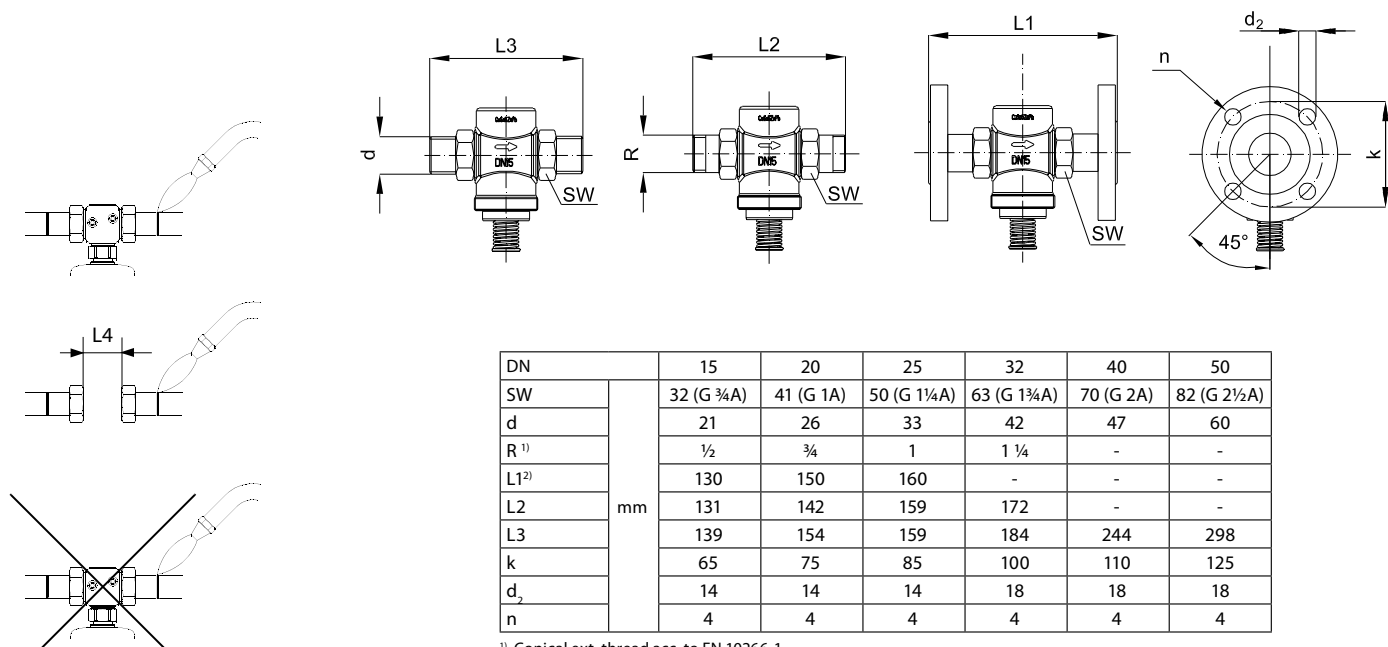

<sup>1)</sup> Conical ext. thread acc. to EN 10266-1

<sup>2)</sup> Flanges PN 25, acc. to EN 1092-2

According to EN 1092-2, EN 1092-3

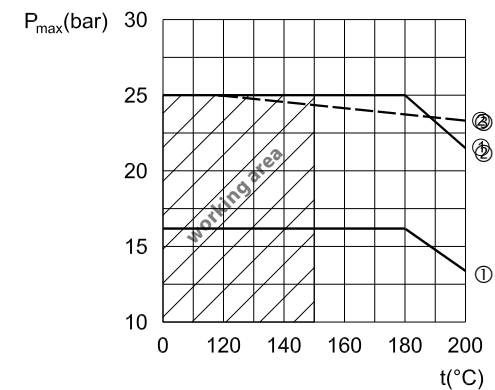

① CuSn5ZnPb (Rg5) PN 16

② CuSn5ZnPb (Rg5) PN 25

③ EN-GJS-400-18-LT (GGG 40.3) PN 25